

# Technical data sheet

External corner, for device installation trunking Rapid  
45-2 type GA-53130  
Item no. 6112513



External corner 90° aluminium for changing the direction of device installation trunking Rapid 45-2 GA...

Note:

For anodised device installation trunking and fittings made from aluminium, light colour differences caused by permitted scatter due to the material and process conditions cannot be avoided (according to DIN 17 611). 45 mm devices can be clicked in directly. When using PC/ABS hood fittings, there may be colour differences due to the different materials.



**Alu** Aluminium

**EL** Anodised

## Master data

Item no.	6112513
Type	GA-AS53130EL
Description 1	External corner
Description 2	Aluminium, rigid form
Dimension	190x190x130
Material	Aluminium
Material symbol	Alu
Surface	Anodised
Surface symbol	EL
Smallest sales unit (VG)	1 Piece
Weight	117,70 kg/100 pc.

## Technical data

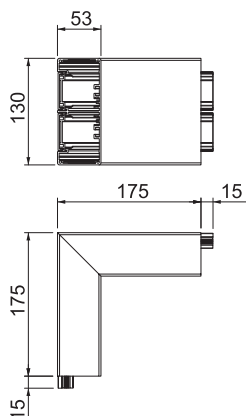

Length	2.000,00 mm
Width	130,00 mm
Height	53,00 mm
Number of covers	2
Version for	Base and cover
for duct dimension	53 x 130 mm
for duct width	130,00 mm
for trunking height	53,00 mm
Cable retaining clip	<input type="checkbox"/>
Duct connector	<input type="checkbox"/>
Cover mounting type	Internal
Mounting perforation in base	<input type="checkbox"/>
Cover width	45 mm
Cover width 2	45,00 mm
Cover width 3	0,00 mm
Protective film	<input checked="" type="checkbox"/>
Symmetrical	<input checked="" type="checkbox"/>
Angle range	90,00 - 90,00 °